

## 2100, AKA U4901 or INT Mechanical Seal for Vacuum Pumps, Submerged Motors, Compressors, and Decelerators

### 2100 (U4901/INT)型机械密封



**Structural Features:** single end, balanced, independent direction of rotation, rubber bellow, bellow transmission mechanical seal. This component seal has a compact structure and good compatibility and it is easy to install. The bellow and the spring provide pressure compensation to the sealing faces. The rubber bellow design can prevent radial run-out so the floatability of the rotary ring is increased.

**结构特点:** 单端面, 平衡型, 任意旋向, 橡胶波纹管传动。结构紧凑, 兼容性较强, 安装方便。波纹管与弹簧提供压力补偿使密封端面贴合更加紧密; 波纹管可补偿轴的径向跳动, 提高了动环的浮动性。

**Standards:** DIN24250, ISO3069, GB6556, EN12756  
**符合标准:** DIN24250, ISO3069, GB6556, EN12756

**Scopes of Application:** mainly used in centrifugal pumps, vacuum pumps, submerged motors, compressor, agitation

equipment and decelerators for sewage treatment, chemical engineering, pharmacy, paper making and food processing. This component can work as an alternative to the similar product of John Crane.

**应用领域:** 广泛应用于污水处理、化工、制药、造纸、食品等领域。可同污水泵、暖通泵、清水泵、管道泵、潜水电机、真空设备等旋转设备配套。

**Inner Diameter:** 10 mm to 100 mm  
**规格范围:** 10 mm - 100 mm

#### Materials

Rotary Ring Face: Carbon/SiC/TC  
Stationary Ring Face: Al<sub>2</sub>O<sub>3</sub>/SiC/TC  
Elastomers: NBR/EPDM/Viton  
Springs: SS304/SS316  
Metal Parts: SS304/SS316

#### 材料

旋转环端面: 石墨/碳化硅/碳化钨  
静止环端面: 氧化铝/碳化硅/碳化钨  
辅助密封: 丁腈橡胶/三元乙丙胶/氟橡胶  
弹簧: SS304/SS316  
金属部件: SS304/SS316

#### Operation Parameters

Pressure:  $\leq 1.2$  MPa  
Temperature: -20 ~ 120 °C  
Linear Speed:  $\leq 10$  m/s

#### 运行参数

压力:  $\leq 1.2$  MPa  
温度: -20 ~ 120 °C  
线速度:  $\leq 10$  m/s

**适用介质:** 油、水、污水、食品、纸浆等弱腐蚀性介质。

**Mediums:** oil, water, sewage, food, paper pulp and other weak-corrosion content.

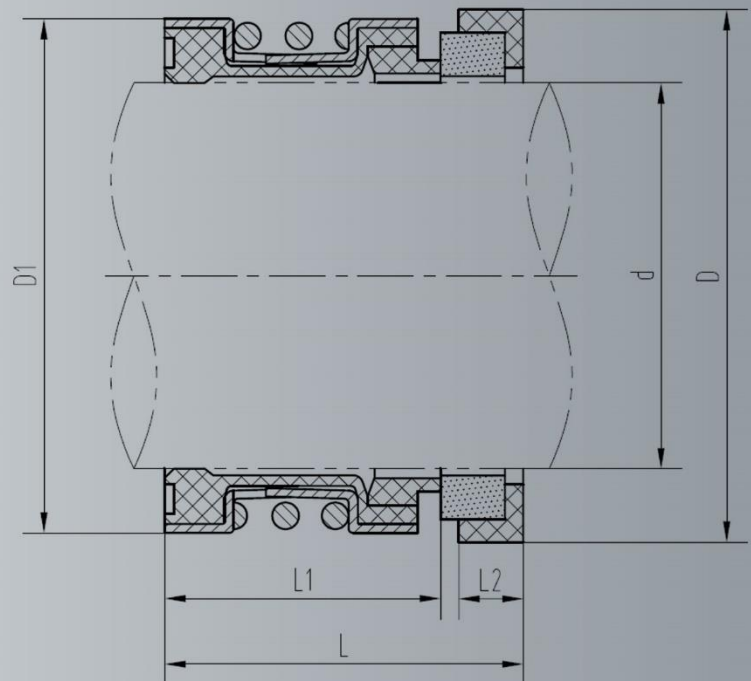

**2100, AKA U4901 or INT Mechanical Seal Dimension Chart**  
- 2100 (U4901/INT)型机械密封尺寸对照表

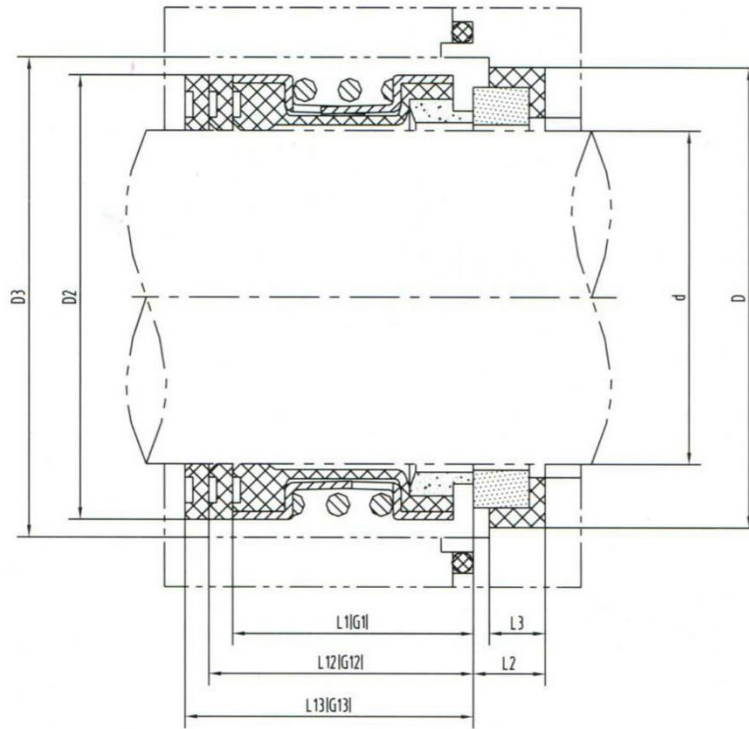

Dimensions	d	D	D2	D3	L1	L12	L13	L2	L3
<b>Shaft Sizes</b>	h6	H8			±0.5	±0.5	±0.5		
12	12	23	22	24	15	26.5	34.0	5.0	4.5
14	14	25	24	26	15	29.0	34.0	5.0	4.5
16	16	27	26	28	15	29.0	34.0	5.0	4.5
18	18	33	32	34	20	31.5	39.0	7.5	6.0
20	20	35	34	36	20	31.5	39.0	8.0	6.5
22	22	37	36	38	20	31.5	39.0	8.0	6.5
24	24	39	38	40	20	34.0	44.0	8.0	6.5
25	25	40	39	41	20	34.0	44.0	8.0	6.5
28	28	43	42	44	26	36.5	44.0	8.0	6.5
30	30	45	44	46	26	35.5	43.0	9.0	7.5
32	32	48	46	48	26	35.5	48.0	9.0	7.5
33	33	48	47	49	26	35.5	48.0	9.0	7.5
35	35	50	49	51	26	34.5	47.0	9.0	7.5
38	38	56	54	58	30	37.0	47.0	9.0	7.5
40	40	58	56	60	30	37.0	47.0	9.0	7.5
43	43	61	59	63	30	37.0	52.0	9.5	8.0
45	45	63	61	65	30	37.0	52.0	9.5	8.0
48	48	66	64	68	30	35.0	50.0	9.5	8.0
50	50	70	66	70	30	37.5	50.0	9.5	8.0
53	53	73	69	73	30	37.5	60.0	9.5	8.0
55	55	75	71	75	30	37.5	60.0	9.5	8.0
58	58	78	78	83	33	42.5	60.0	9.5	8.0
60	60	80	80	85	33	40.5	58.0	9.5	8.0
63	63	83	83	88	33	40.5	58.0	9.5	8.0
65	65	85	85	90	33	40.5	68.0	9.5	8.0
68	68	90	88	93	33	40.5	68.0	9.5	8.0
70	70	92	90	95	33	48.0	68.0	11.0	9.5
75	75	97	99	104	40	48.0	68.0	12.0	10.0
80	80	105	104	109	40	47.5	77.5	12.0	10.0
85	85	110	109	114	40	47.5	77.5	12.0	10.0
90	90	115	114	119	40	52.5	77.5	12.0	10.0
95	95	120	119	124	40	52.5	77.5	14.0	11.0
100	100	125	124	129	40	52.5	77.5	14.0	11.0